

DISCOVER MORE FROM YOUR DREAM HOME



DISCOVER THE ELLIOT HOMESTYLE

A typical Elliot



## THE ELLIOT HOMESTYLE

More than just a four bedroom home, The Elliot is a spacious family home that offers truly flexible living.

Enjoy four generous bedrooms with an additional study on the ground floor, as well as a detached garage with two levels and living space above – for a home that grows with you.

This is life with more style. This is The Elliot.

A typical Elliot showhome





A typical Elliot showhome



Accommodation area over the garage

“The finish of the house is really good, all of the little details are really good and the quality is done to a really high standard.”

A RECENT CALA HOMES  
WEST PURCHASER

THIS IS THE BEST OF  
STYLE AND PRACTICALITY  
THIS IS ROOM TO GROW

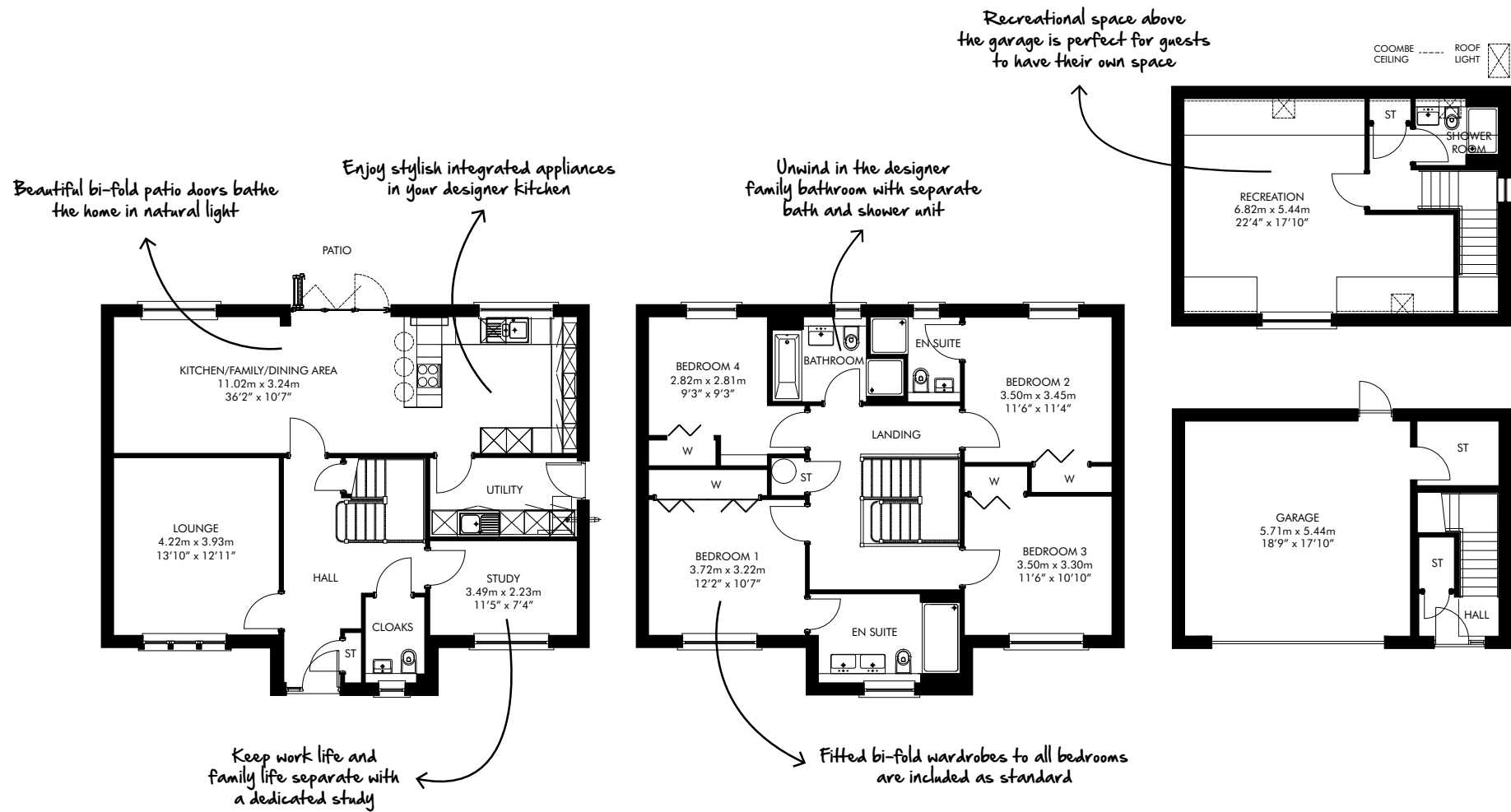



## A HIGHER SPECIFICATION AS STANDARD

### KITCHENS

Busy homes make bigger demands, so we've taken the pressure off meal times with quality appliances. Friends or family gathering? Cater for even the largest dinner party and, with a built in dishwasher, clean up in no time.

We all have our 'Where can we put that?' moments. Our utility room provides every family with the perfect hideaway.



### BEDROOMS

With generous proportions the main bedroom can be your go-to sanctuary. The addition of luxurious en suites put an end to morning rush hour queues for the family bathroom.

### BATHROOMS

Wake up with a shower or wind down in a relaxing bath in your Laufen designer bathroom, complete with full-height Porcelanosa tiling, chrome towel warmers and practical storage space.

### EXTERNAL

As soon as the sun appears our outdoor spaces are good to go. Last minute BBQ's are no problem with a generous patio, external taps and 1.8m privacy fence.

### SECURITY

It should come as no surprise to learn that your safety and security are our priority and that's why every home comes with an alarm system, mains-wired smoke detectors and battery operated CO detectors.





CALA.CO.UK

IMPORTANT NOTICE TO CUSTOMERS: The Consumer Protection from Unfair Trading Regulations 2008. CALA Homes (West) Limited operates a policy of continual product development and the specifications outlined in this brochure are indicative only. CALA reserves the right to implement minor changes to the sizes and specifications shown on any plans or drawings in this brochure without warning. Where alterations to the design, construction or materials to be used in the construction of the property would materially alter the internal floor space, appearance or market value of the property, we will ensure that these changes are communicated to potential purchasers. Whilst these particulars are prepared with all due care for the convenience of intending purchasers, the information is intended as a guide. The computer generated images and photographs do not necessarily represent the actual finishings/elevation or treatments, landscaping, furnishings and fittings at this development. Floor plans, dimensions and specifications are correct at the time of print. Nothing contained in this brochure shall constitute or form part of any contract. Information contained in this brochure is accurate at time of going to press on **XX.XX.21**. CALA (West) Limited, registered in Scotland company number SC222577. Registered office: Johnstone House, 52-54 Rose Street, Aberdeen AB10 1HA: Agent of CALA Management Limited.